

2A-130G

VGA EDID Emulator

Quick Start Guide

© Copyright 2023 ATEN® International Co. Ltd.
ATEN and the ATEN logo are registered trademarks of ATEN International Co., Ltd. All rights reserved. All other trademarks are the property of their respective owners.

Part No. PAPE-1285-441G Released: 06/2023



Support and Documentation Notice

All information, documentation, firmware, software utilities, and specifications contained in this package are subject to change without prior notification by the manufacturer.

To reduce the environmental impact of our products, ATEN documentation and software can be found online at <http://www.aten.com/download/>

Technical Support
www.aten.com/support

Scan for more information

Product Page



Package Contents

- 1 2A-130G VGA EDID Emulator
- 1 User Instructions

A Hardware Review

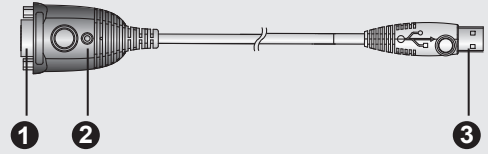

B Hardware Installation

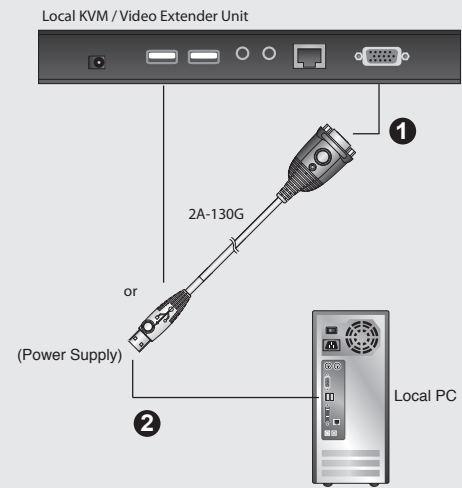

Hardware Review A

The 2A-130G is designed for ATEN KVM extender or video extender installations that do not utilize a local monitor at the site where the computer/video source is located. The 2A-130G emulates and stores a default ATEN EDID (Extended Display Identification) so that the local PC can boot with no problems.

1. Plug the 2A-130G's VGA connector into the local monitor's VGA port on your local KVM extender or video extender unit.
2. Plug the 2A-130G's USB connector into any available USB port on your local Extender or computer. This provides power to the 2A-130G.

Note: The 2A-130G takes power from the VGA port and the power LED should light up. If the VGA port cannot provide power, connect the 2A-130G to the USB port on your local Extender or computer.

3. Connect the rest of your ATEN KVM extender or video extender installation according to the installation instructions in the Quick Start Guide.

Compatible devices:

The 2A-130G works with the following ATEN KVM extenders, video extenders and video splitters:

Compatible Extenders: CE774, CE775, CE700A, CE750, CE770, CE800B, CE350, CE370, CE250A, CE252, VE150A, VE170, VE200, VE300T, VE500T, VS1204T, VS1208T, VS1504T, VS1508T

Compatible Splitters (Connect to Port1): VS132A/134A/138A, VS92A/94A/98A, VS82/84/88, VS0116, VS132, VS102

Supported Resolutions B

Standard Timings Supported
640 x 480 at 60Hz Industry STD
800 x 600 at 60Hz VESA
1024 x 768 at 60Hz VESA
1366 x 768 at 60Hz VESA
Extra Timings Supported
1280 x 720p at 60Hz – CEA STD
1280 x 800 at 60Hz – VESA STD
1280 x 1024 at 60Hz – VESA STD
1440 x 900 at 60Hz – VESA STD
1600 x 1200 at 60Hz – VESA STD
1680 x 1050 at 60Hz – VESA STD
1920 x 1080p at 60Hz – CEA STD
1920 x 1200 at 60Hz – VESA STD