

# Instruction Manual

- ① Remove the wiring cap before installation.

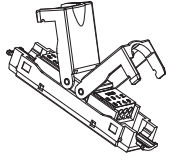

JACK PIN DESIGNATIONS	TIA/EIA T568A	TIA/EIA T568B
	1 White/Green	white/Orange
	2 Green	Orange
	3 white/Orange	White/Green
	4 Blue	Blue
	5 white/Blue	white/Blue
	6 Orange	Green
	7 White/Brown	White/Brown
	8 Brown	Brown

## Boot adjustment

Cut the end of boot to fit your cable OD.

- ② Insert cable into strain relief boot, strip off 1.2 inch of cable jacket, fold back braid and drain wire.

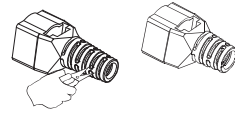
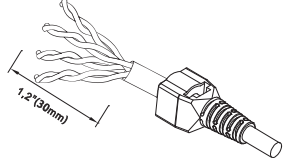

- ③ Fan out all four twisted pairs, following the color coding label and allocate each conductor into proper slots on wiring cap. Trim the ends of conductors.

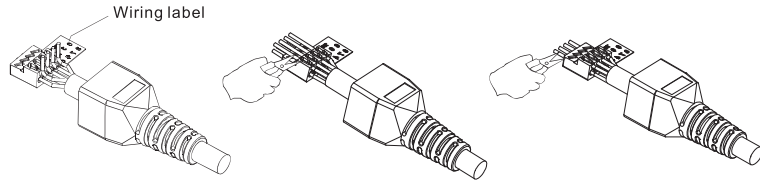

- ④ Place wiring cap on connection module.

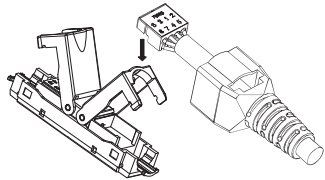

- ⑤ Place the wiring cap onto connection module, use plier to clamp wiring cap until it completely snap-in to effect the connection.

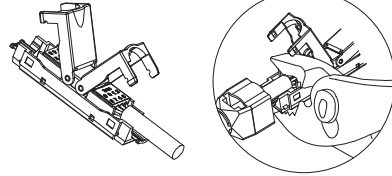

- ⑥ Close connection module cover, make sure the drain wire is in proper contact with grounding clip on connection module. Pull back strain relief boot to cover the connection module, fasten supplied cable tie to secure grounding contact.

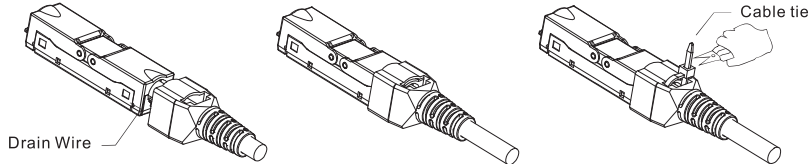

## Unload the cable

Cut off cable tie, remove the boot. Using flat screw driver and pry gently on connection module cover one end first and the other end subsequently to open it.

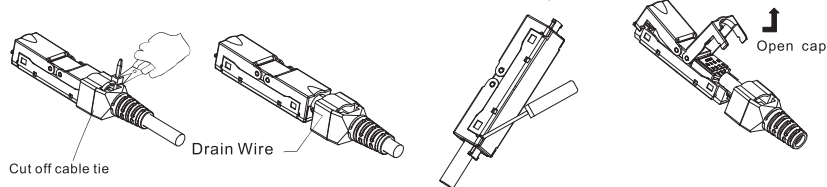

# Instruction Manual

- ① Remove the wiring cap before installation.

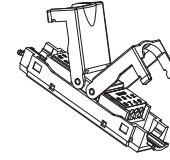

JACK PIN DESIGNATIONS	TIA/EIA T568A	TIA/EIA T568B
	1 White/Green	white/Orange
	2 Green	Orange
	3 white/Orange	White/Green
	4 Blue	Blue
	5 white/Blue	white/Blue
	6 Orange	Green
	7 White/Brown	White/Brown
	8 Brown	Brown

## Boot adjustment

Cut the end of boot to fit your cable OD.

- ② Insert cable into strain relief boot, strip off 1.2 inch of cable jacket, fold back braid and drain wire.

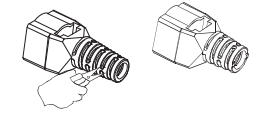
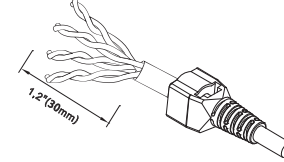

- ③ Fan out all four twisted pairs, following the color coding label and allocate each conductor into proper slots on wiring cap. Trim the ends of conductors.

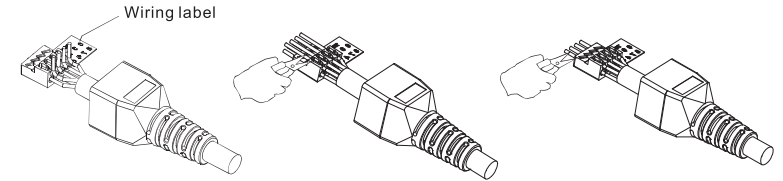

- ④ Place wiring cap on connection module.

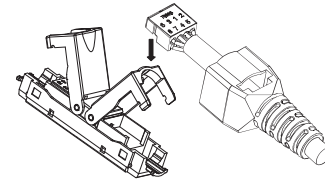

- ⑤ Place the wiring cap onto connection module, use plier to clamp wiring cap until it completely snap-in to effect the connection.

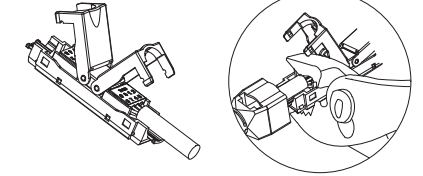

- ⑥ Close connection module cover, make sure the drain wire is in proper contact with grounding clip on connection module. Pull back strain relief boot to cover the connection module, fasten supplied cable tie to secure grounding contact.

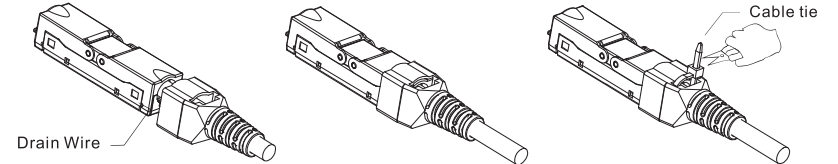

## Unload the cable

Cut off cable tie, remove the boot. Using flat screw driver and pry gently on connection module cover one end first and the other end subsequently to open it.

